

Medical Office Systems, LLC

December 2015, Issue #1
More Windows 10 Tune-Ups

In Windows 10, Microsoft has packed not one, but two browsers into the operating system. The newest and best (my opinion) browser is named "Edge". Similar to Internet Explorer (hereinafter referred to as "IE"), Edge sheds the baggage, dreck, and bad reputation of IE for a new, clean interface and startlingly fast performance. Did I forget to say Edge is also far more secure than FireFox and perhaps even Chrome? There, I said it.

Why did Microsoft include both? They want you to use Edge, but kept Internet Explorer for backwards compatibility.

The new Edge Browser top border looks like this:

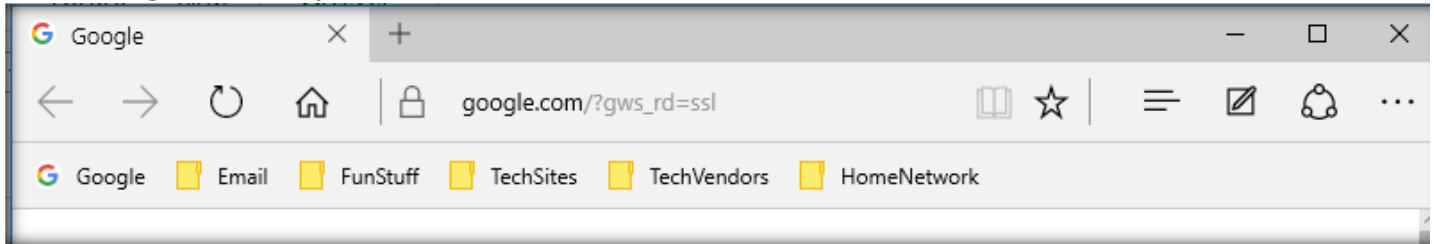

The (old) Internet Explorer top border looks like this:

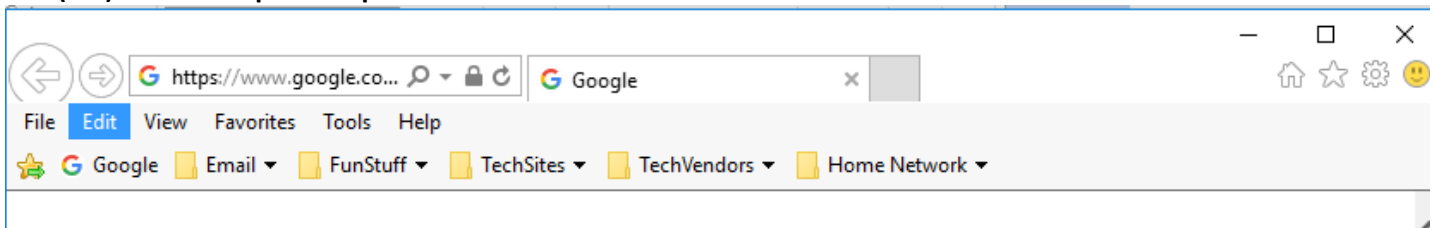

To Import Favorites from Internet Explorer:

1. Click the "three lines" icon
2. Then, Click the "Import Favorites" link

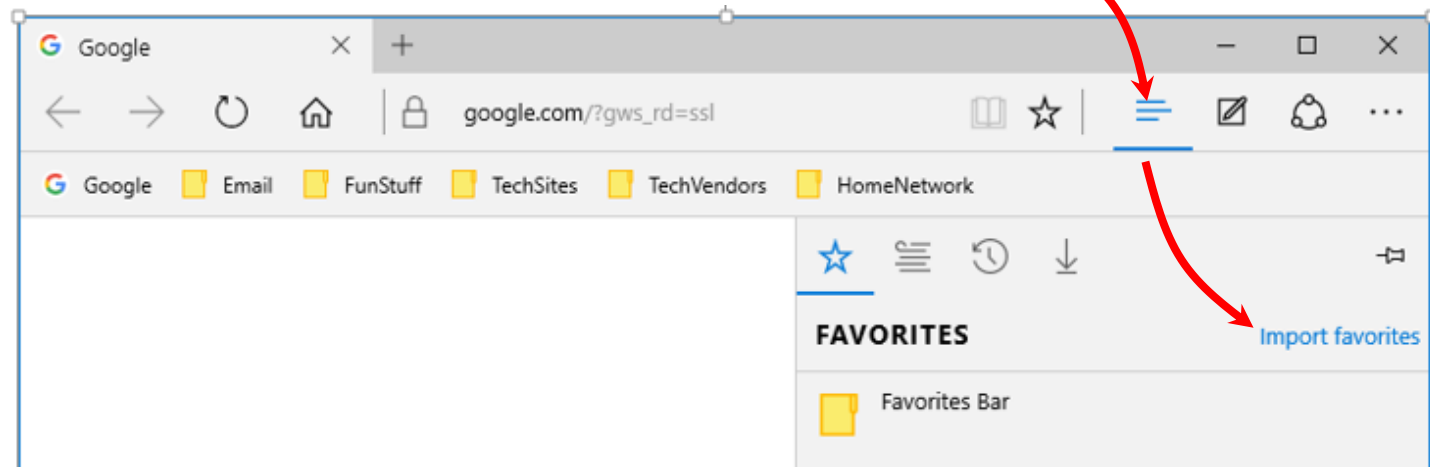

[Next Page]

Reprint permission granted, provided the following appears on each page:
Copyright © 2015, Medical Office Systems, L.L.C. - www.medofficesystems.com

Phone: 630-852-1736

john@medofficesystems.com

Fax: 630-214-4565

Medical Office Systems, LLC

3. You can choose which browser to import from... I selected only Internet Explorer

NOTE: you can select as many as you like... I could have imported from Google Chrome too...

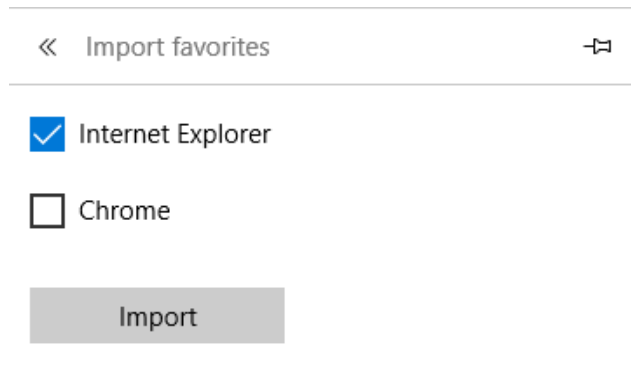

4. Now your favorites are imported into Edge, and you may use them as you did in Internet Explorer

5. Bonus Tip: Use the Favorites Bar:

- a. If you want to show the Favorites Bar (very handy) do this:
- b. Click the "Three Dots" menu, then click the "Show Favorites Bar" slider

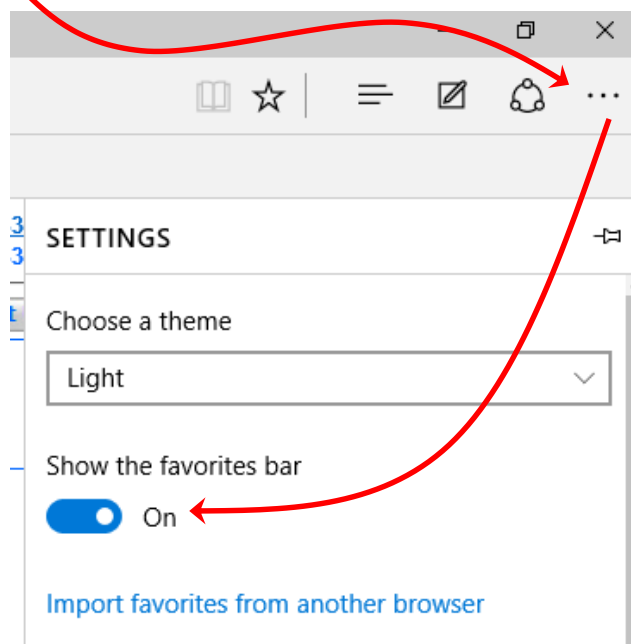

[Next Page]

Reprint permission granted, provided the following appears on each page:
Copyright © 2015, Medical Office Systems, L.L.C. - www.medofficesystems.com

Phone: 630-852-1736

john@medofficesystems.com

Fax: 630-214-4565

- c. Now that your Favorites Bar is displayed, you can arrange it to your liking
- d. You can create folders (with a Right-Click) to arrange your favorites by folder group
- e. Below is an example how I arranged my Favorites into a grouped list.

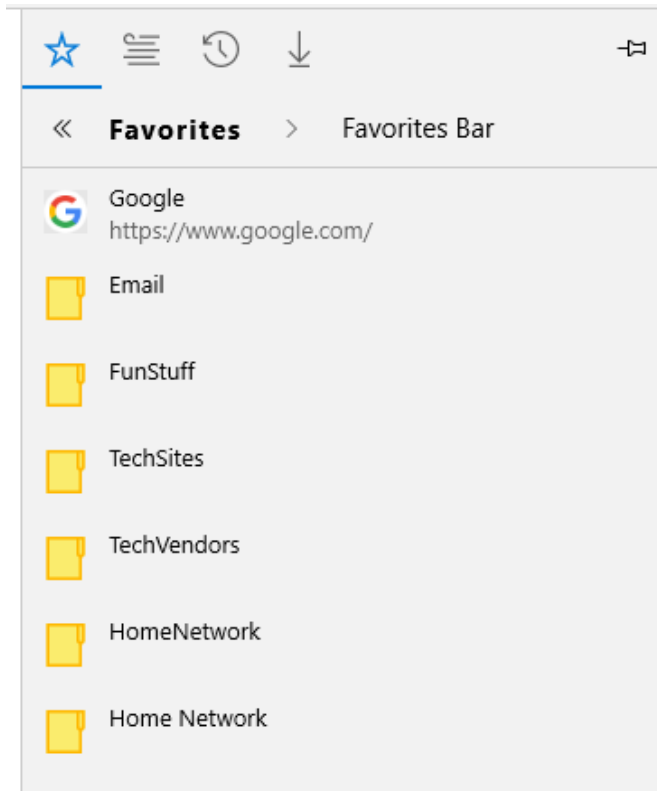

6. Adding items to the Favorites Bar

- a. Here's where things get "clunky"...
- b. Bad News: you can't really move or copy from the Favorites to the Favorites Bar
- c. Good News: it is easy to add them as a new item... here is an example how to do so:

[Next Page]

Medical Office Systems, LLC

Adding Web Sites to the Favorites Bar

- i. Step1: open (goto) one of your favorite websites that you want to put in the Favorites Bar.
- ii. Step2: in this example, I want to add my own website, so I click the "Star" menu
- iii. Step3: click the Favorites icon, then click the drop-down list and select the desired folder

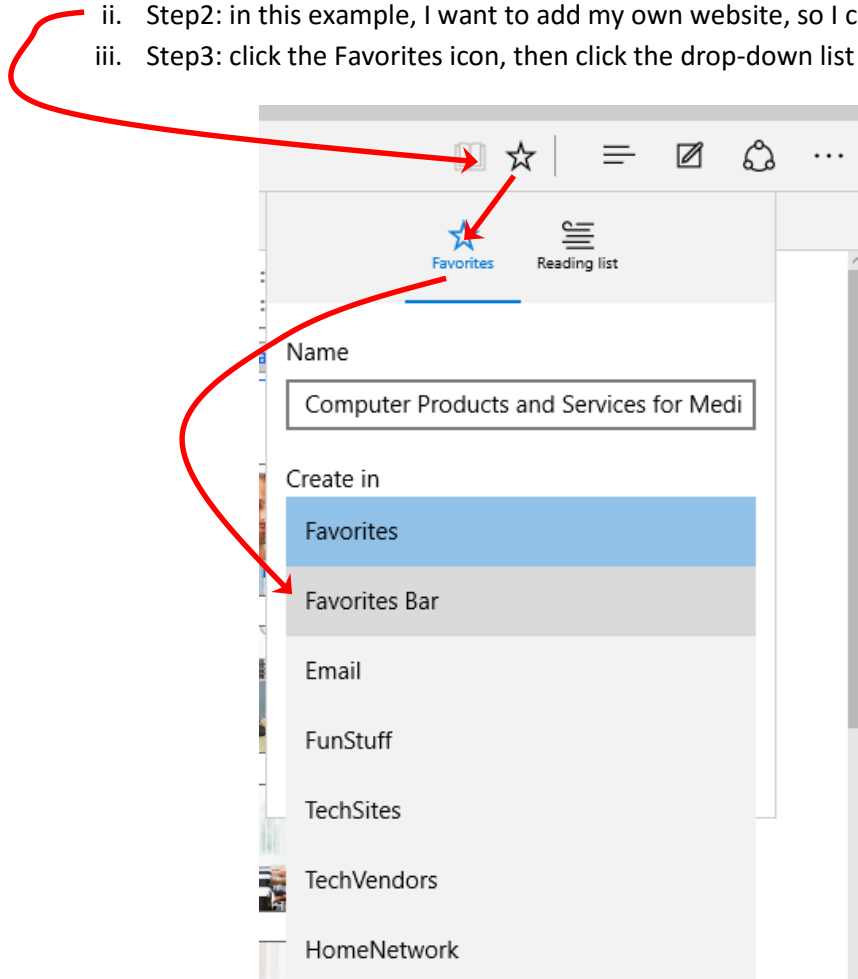

Now my website is in my Favorites Bar menu:

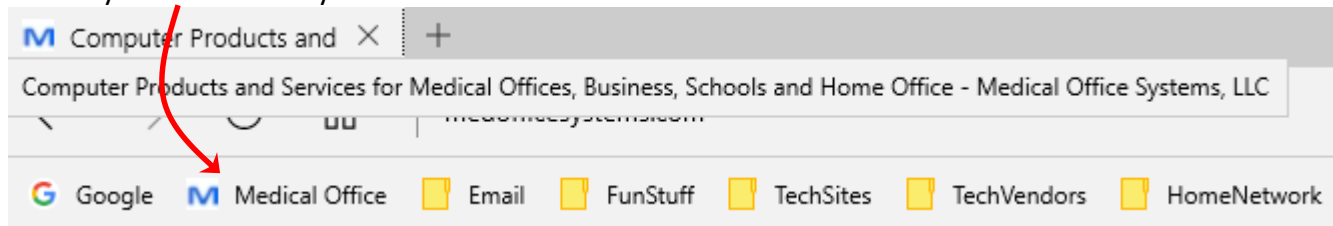

I hope this guide will help Windows 10 users become comfortable with the new Edge browser. As always please call me if you have questions or problems.

-John Becker

Reprint permission granted, provided the following appears on each page:
Copyright © 2015, Medical Office Systems, L.L.C. - www.medofficesystems.com

Phone: 630-852-1736

john@medofficesystems.com

Fax: 630-214-4565